

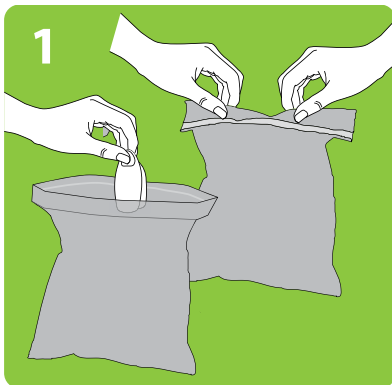

How to dispose of your Pods— The earth-friendly way

Returning your Pods to our earth-friendly disposal program is quick and easy. It also makes a huge difference to the environment, by minimizing landfill and removing hazardous waste. Thank you for participating.

Use these materials to return up to 50 Pods. If you have more than 50 Pods, please call Customer Care at 800.591.3455 to request an additional kit.



1
Place your used
Pods in the blue bag.
Seal the bag.



2
Place the blue bag
in the FedEx Large Pak.
Seal the Pak.



3
Attach the enclosed shipping
label to the outside of
the FedEx Large Pak, in the
space indicated.

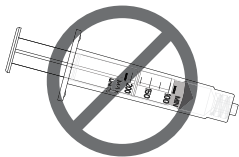

Only include Pods. **DO NOT** include syringes in the bag. These cannot be recycled, and will prevent the Pods from being processed.

Call **800.463.3339** or visit **www.FedEx.com** to find the nearest drop-off location.

🔗 Questions?

Please call Customer Care at 800.591.3455.
We'd be happy to help you out.



Insulin Management System